

LOCATION PLAN AT K.M.C. PREMISES NO.- 99, RAJA RAM MOHAN ROY ROAD, WARD NO.- 121 UNDER BOROUGH -XIV

AREA OF LAND AS PER BOUNDARY DECLARATION = 267.551 SQM.

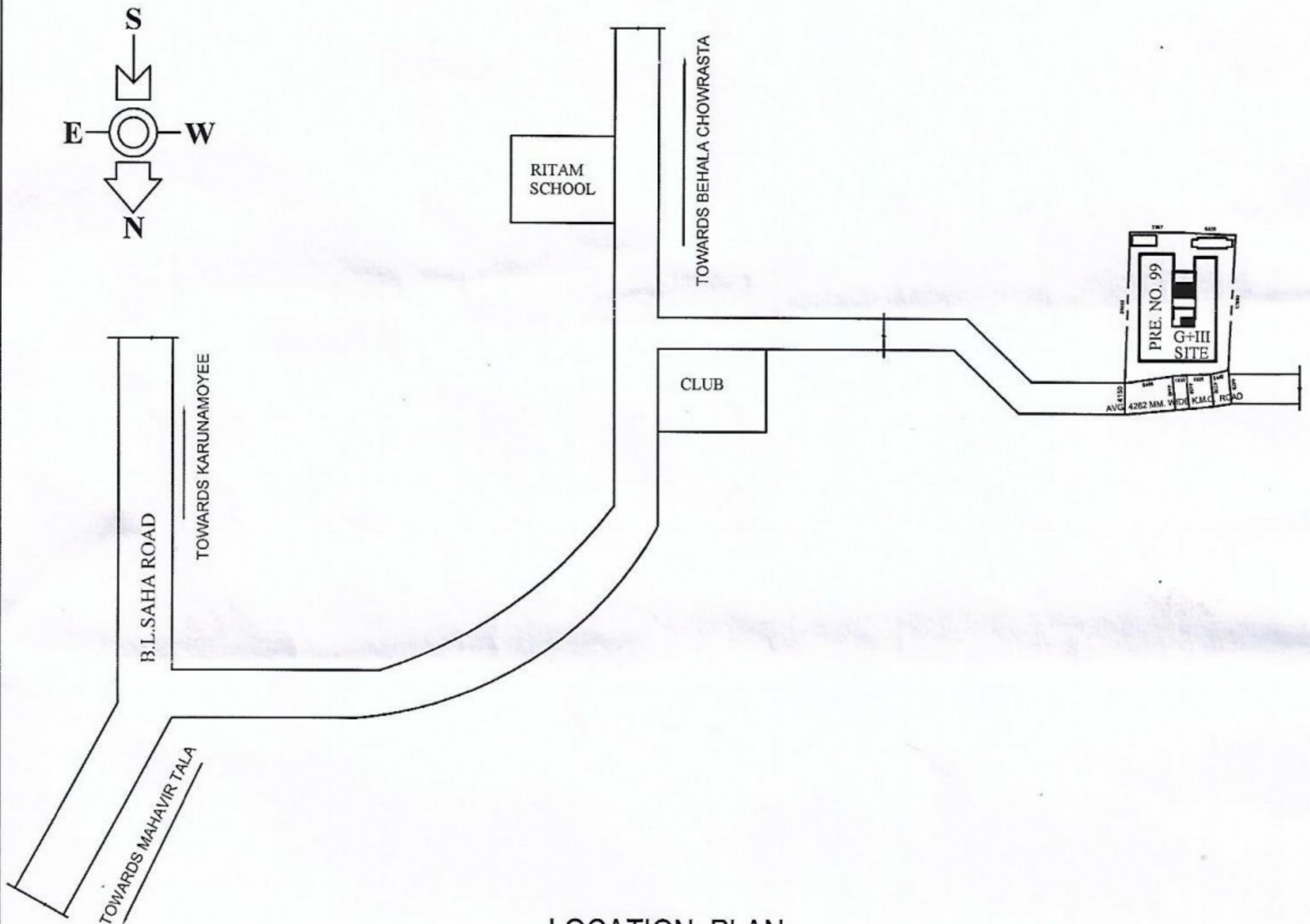

LOCATION PLAN

SCALE = 1:4000

*Baidya with Adhikary*

SIG. OF DIRECTOR

*Swapan K. Chowdhury*  
*Swapan K. Chowdhury*

D.C.E., A.M.I.E.

LBS Class-I, No-1132  
The Kolkata Municipal Corporation

SIG. OF L.B.S.

SITE PLAN AT K.M.C. PREMISES NO.- 99, RAJA RAM MOHAN ROY ROAD,  
WARD NO.- 121 UNDER BOROUGH -XIV

AREA OF LAND AS PER BOUNDARY DECLARATION = 267.551 SQM.

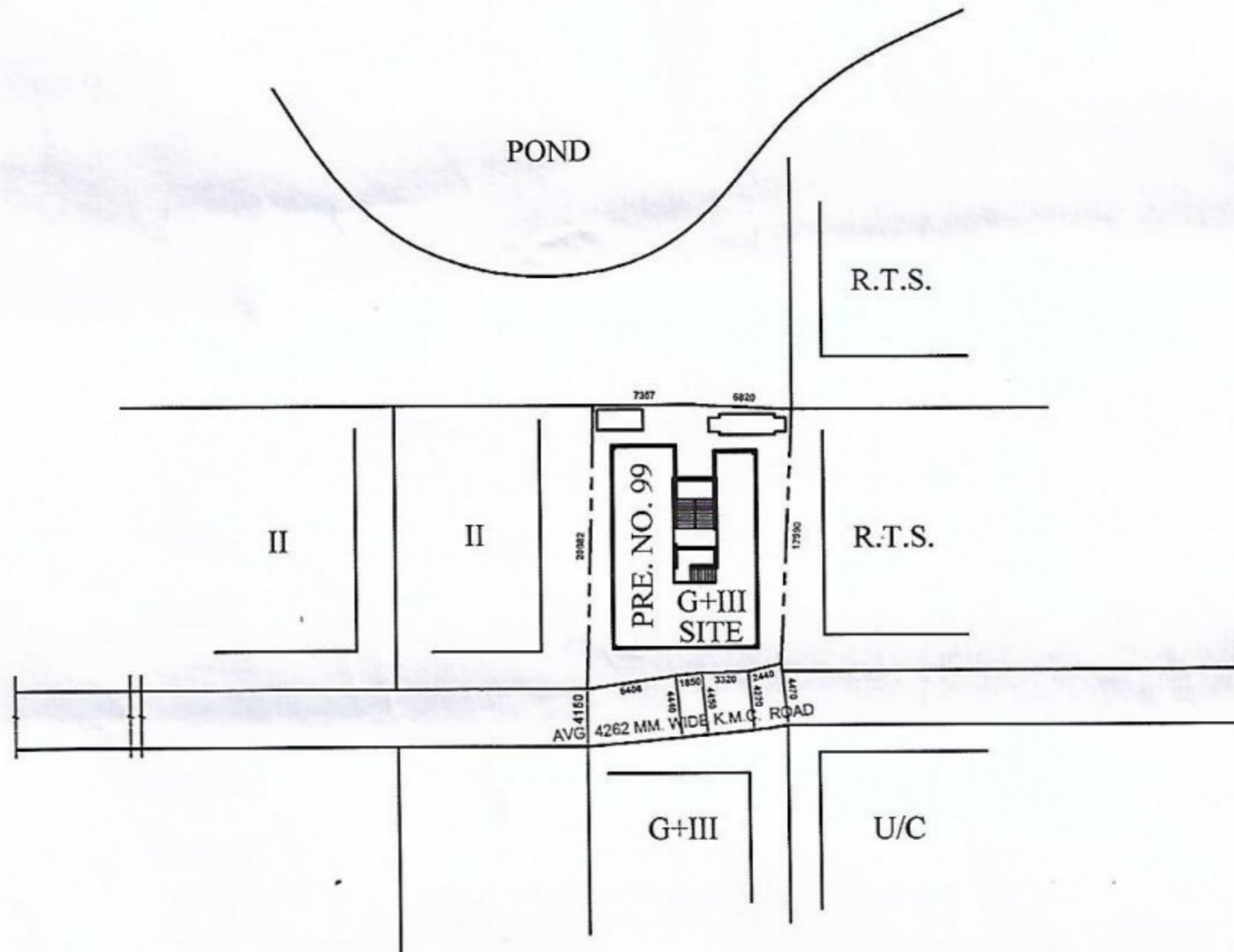
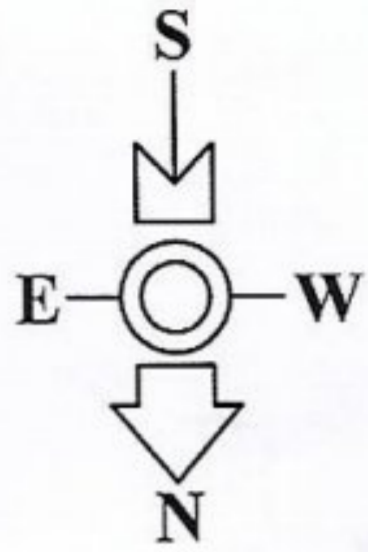

SITE PLAN

SCALE = 1:600

*Baidya Nath Adhikary*

SIG. OF DIRECTOR

*Swapan Kr. Chowdhury*

Swapan Kr. Chowdhury  
D.C.E.A.M.I.S.

LBS Class-I, No-1132  
The Kolkata Municipal Corporation

SIG. OF L.B.S.